



Windows 重新启动后 ONTAP SAN LUN 消失

https://kb-cn-stage.netapp.com/on-prem/ontap/da/SAN/SAN-KBs/ONTAP_SAN_after_Windows_reboot...

Updated: Wed, 22 Apr 2026 07:02:37 GMT

适用于

- ONTAP 9.14 及更高版本
- SnapMirror

问题描述

- LUN 移动和释放 Snapmirror 一致性组的基础 Snapshot 后 LUN 消失
- 配置 MPIO 时 SCSI 磁盘条目移至隐藏状态
- Microsoft MPIO 在 LUN 迁移后显示 Event ID 47 且所有目标端口的设备名称显示 Disk -1 :

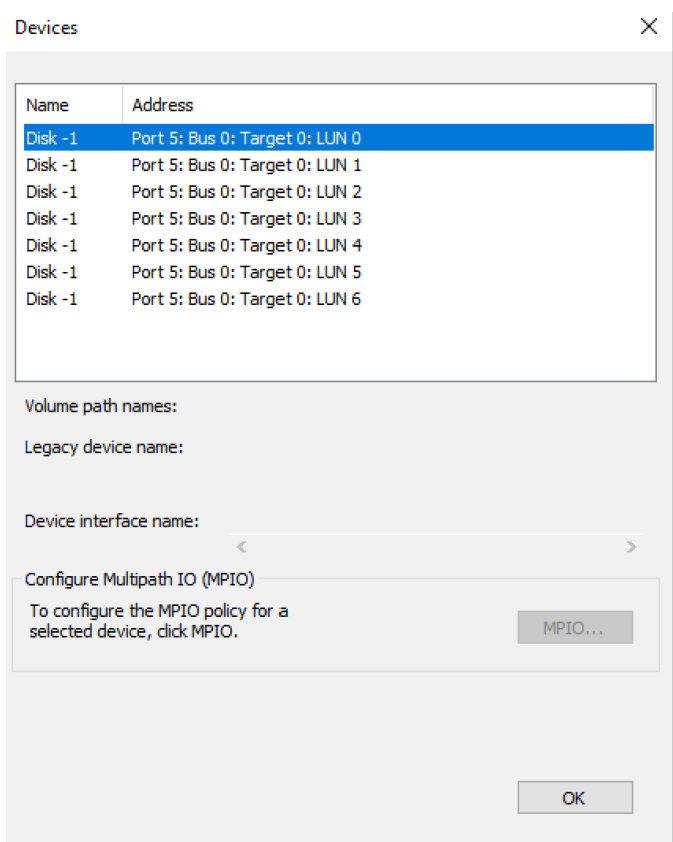

- 新 target-port-groups ID 以更高的顺序创建（即 13e9 位于原始 13e8 之前），并将 report_new_rtpgids flag 设置为 1

```
cluster2::*> debug san lun show-target-port-groups
Vserver Node          Path Target Port Groups
```

```
-----
svm1_cluster2        /vol/NetApp/NetApp
<snip>
                /vol/vol_sql1_db_dest/sql1_db
cluster2-01         13e9 Active/Non-Optimized: 2
                   13e8 Active/Optimized: 1
cluster2-02         13e9 Active/Non-Optimized: 2
                   13e8 Active/Optimized: 1
```

```
cluster2::*> statistics show -object lun -counter scsit_lu_flag_status -node
cluster2-01 -raw
```

```
Object: lun
Instance: /vol/vol_sql1_db_dest/sql1_db
Start-time: 1/8/2025 14:02:33
End-time: 1/8/2025 14:02:33
Scope: svm1_cluster2
```

Number of Constituents: 1 (complete_aggregation)

Counter	Value
-----	-----
scsit_lu_flag_status	-
lu_readonly	0
report_new_rtpgids	1